

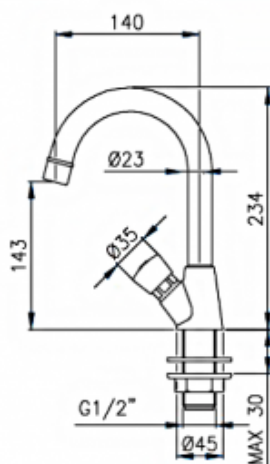

## Self-closing basin tap with swinging spout 9091

- The body is made of chrome-plated brass Swivel spout Long spout
- Three variants: 9091 universal, 9091 / M with concealed mixer, and 9091AB with anti-block system
- Water flow time adjustment (available for variant 9091 and 9091 / M)
- Water pressure reduction in the form of a cup and water flow reducer
- High resistance to vandalism (the 9091AB variant has additional protection in the form of an anti-block system)
- Exceptional durability and reliability
- The product is made in the European Union
- Simple operation
- Easy to assemble
- Certificate of the Polish Institute of Hygiene
- CE declaration of conformity
- National Declaration of Performance

Option	For mixed water
Connector	1/2 "
Mixer	2xG1 / 2 under-basin - only with 9091/ M
Design	Chrome-plated brass
Water time flow	Adjustable from 10 seconds $\pm$ 3 second
Start	By means of the button
Water pressure reductor	up to 6l / min.
Water temperature	5-65°C
Water pressure	Min 0,5 bar - Max 6 bar (Recommended 2-4 bar)
Contains	Battery, mounting kit for the washbasin



Timer, washbasin faucet with extended and swivel spout The 9091 faucet has one G1 / 2 connection for cold or mixed water. The faucet body is made of corrosion-resistant brass with a chrome layer. A single flow of water takes 10 seconds  $\pm$  3 seconds. The amount of water used with a single outflow is 6 l / m (at a pressure of 3 bar). The recommended water connection temperature is 5-65 ° C. The connection pressure may be from 0.5 bar to 6 bar, with the recommended pressure being 2-4 bar.

The 9091 battery is available in three variants:

- 9091 universal variant, equipped with one 1/2 connection and a cup, water flow reducer, and regulation hole;
- 9091 / M variant equipped with 2 x G1 / 2 concealed mixer, cup, flow reducer, and regulation hole;
- 9091AB variant with an integrated anti-block system, which includes a cup and a flow reducer.

The option to adjust the water flow time is not available. Moreover, it is possible to regulate the flow and time of the water flow. Adjustment is possible thanks to the use of:

- a regulating cup located in the head;
- a water flow reducer - included with the faucet, requires manual installation in the connection area;
- the water flow regulating hole in the head. The flow time can be changed with the enclosed allen key. The water flow time adjustment option is not available when the anti-block system is used.

Each 9091 tap is certified by the Polish Institute of Hygiene, CE Declaration of Conformity, and the National Declaration of Performance.