

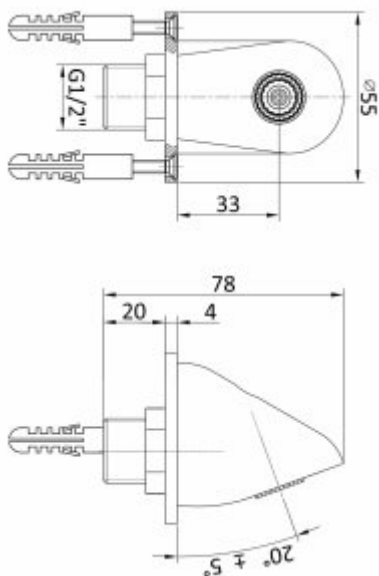

shower spout 9011

- Body made of chrome-plated brass
- High resistance to vandalism due to the use of top-quality materials
- Adjustable screen tilt angle from 10 to 30 degrees
- Exceptional durability and reliability Italian product
- Easy to use Simple installation
- PZH certification

Connector	1/2"
Design	Chrome plated brass
Tilt adjustment	10 to 30 degrees
Contains	Spout, mounting kit



Wall-mounted shower spout with adjustable screen. The spout housing is made of brass coated with chrome. The built-in screen is plastic, and its tilt range can be set from 10 to 30 degrees. The spout has a single G1/2 connection. The water connection temperature should be 5-65°C, with a recommended flow pressure of 2-4 bars. The slim and compact design makes it difficult for users to damage the spout by hanging on it.

Additionally, the shower spout is easy to maintain. The chrome surface is resistant to limescale buildup, making it easy to clean. The durability of the product and its easy installation make the 9011 spout recommended for campsites, baths, swimming pools, gyms, and fitness clubs.